

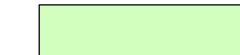





STOCKBRIDGE SEWER SERVICE AREA

-  Village Corporate Limits
-  Township Boundary
- EXISTING BOUNDARY CONDITIONS**
-  2020 Sewer Service Area Boundary
-  Planning Area Boundary Line
- SSA CURRENT DEVELOPMENT STATUS**
-  Developed Areas Within SSA
-  Undeveloped Areas Within SSA
-  Wastewater Treatment Facility
- ENVIRONMENTAL CONDITIONS**
-  WDNR Designated Wetlands
-  Hydro arc
-  50 Foot Wetland Buffer
-  75 Foot Stream Buffer

This map and its associated sewer service allocation areas does not obligate the community(ies) to provide sewer service to property owners contained herein.

This data was created for use by the East Central Wisconsin Regional Planning Commission Geographic Information Systems Department. Any other use application of this information is the responsibility of the user and such use application is at their own risk. East Central Wisconsin Regional Planning Commission disclaims all liability regarding fitness of the information for any use other than for East Central Wisconsin Regional Planning Commission business.

Sources: Wisconsin Department of Natural Resources, Calumet County GIS, ECWRPC

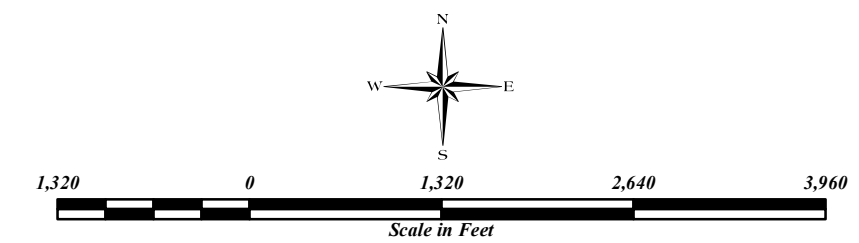

MAP AMENDMENTS			
	Designated Management Agency	Date of WDNR Approval	Track No.
1	Village of Stockbridge - St. Catherine's Bay Rd. (Swap)	September 11, 2009	140
	Development Status Updates	September, 2015	
	Wetland & Stream Buffer Updates	September, 2015	

**EAST CENTRAL WISCONSIN
REGIONAL PLANNING COMMISSION**
400 AHNAP STREET, SUITE 100
MENASHA, WI 54952
(920) 751-4770
Fax (920) 751-4771
Website: www.eastcentralrpc.org
Email: staff@eastcentralrpc.org



Wisconsin Department of Natural Resources Certification Date - April 4, 2001