

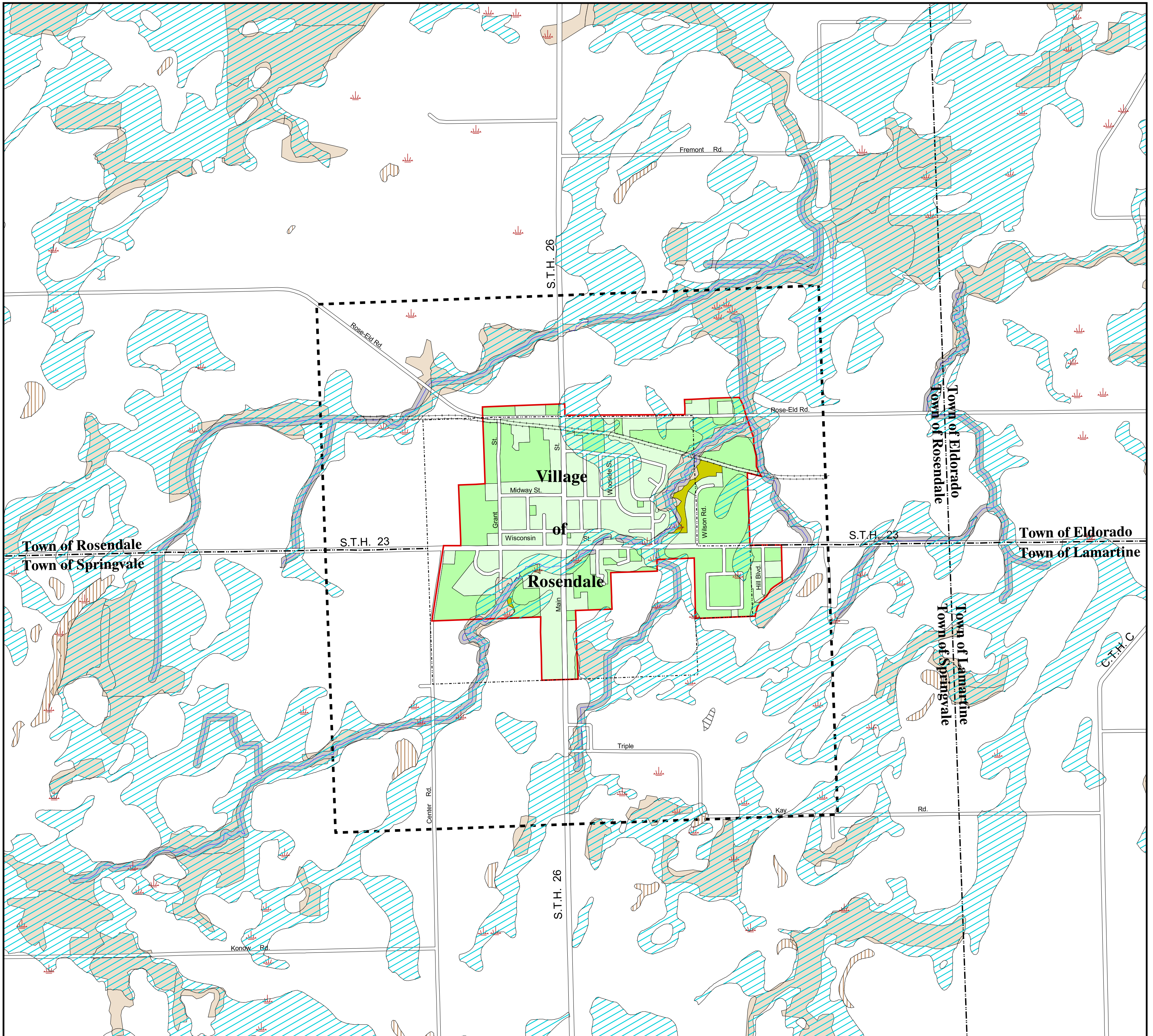







ROSENDALE SEWER SERVICE AREA





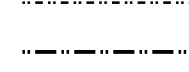

EXISTING SSA CONDITIONS

-  Developed Areas Within Existing SSA
-  Undeveloped Areas Within Existing SSA
-  Undevelopable Areas Within Existing SSA

BOUNDARY LINE LEGEND

-  Sewer Service Area Boundary
-  Planning Area Boundary
-  Corporate Limit Boundary
-  Township Boundary

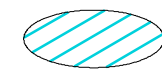
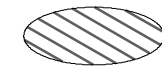
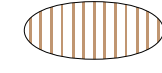
ENVIRONMENTAL CONDITIONS

-  WDNR Designated Wetlands
-  Environmentally Sensitive Areas
-  Groundwater within 2 Feet of Surface
-  Bedrock Within 5 Feet of Surface
-  Slopes Greater Than 12%
-  Wetlands Less Than 5 Acres
-  Streams

This map is neither a legally recorded map nor a survey and is not intended to be used as one. This drawing is a compilation of records information and data used for reference purposes only. ECWRPC is not responsible for any inaccuracies herein contained.

This map and its associated sewer service allocation areas does not obligate the community(ies) to provide sewer service to property owners contained herein.

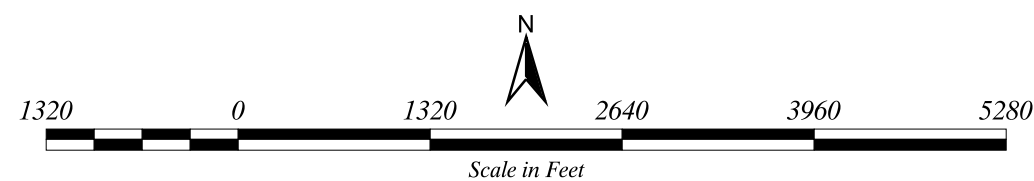

Prepared By: EAST CENTRAL WISCONSIN REGIONAL PLANNING COMMISSION - MAY 2000
 Department of Natural Resources Certification - January 4, 1999

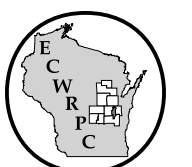

D:\MAP\PLTS\ROSENDALE\FINALSSA.APR