











2035 ROSENDALE SEWER SERVICE AREA

2035 SEWER SERVICE AREA

-  Sewer Service Boundary
-  2050 Planning Area Boundary
-  Village Corporate Limits
-  Township Boundary
-  2035 Sewer Service Area
-  Wastewater Treatment Facility

ENVIRONMENTAL CONDITIONS

-  WDNR Designated Wetland
-  75 Foot Stream Buffer
-  50 Foot Wetland Buffer
-  Streams

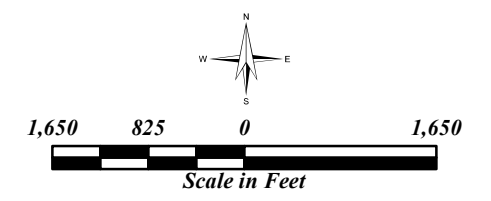
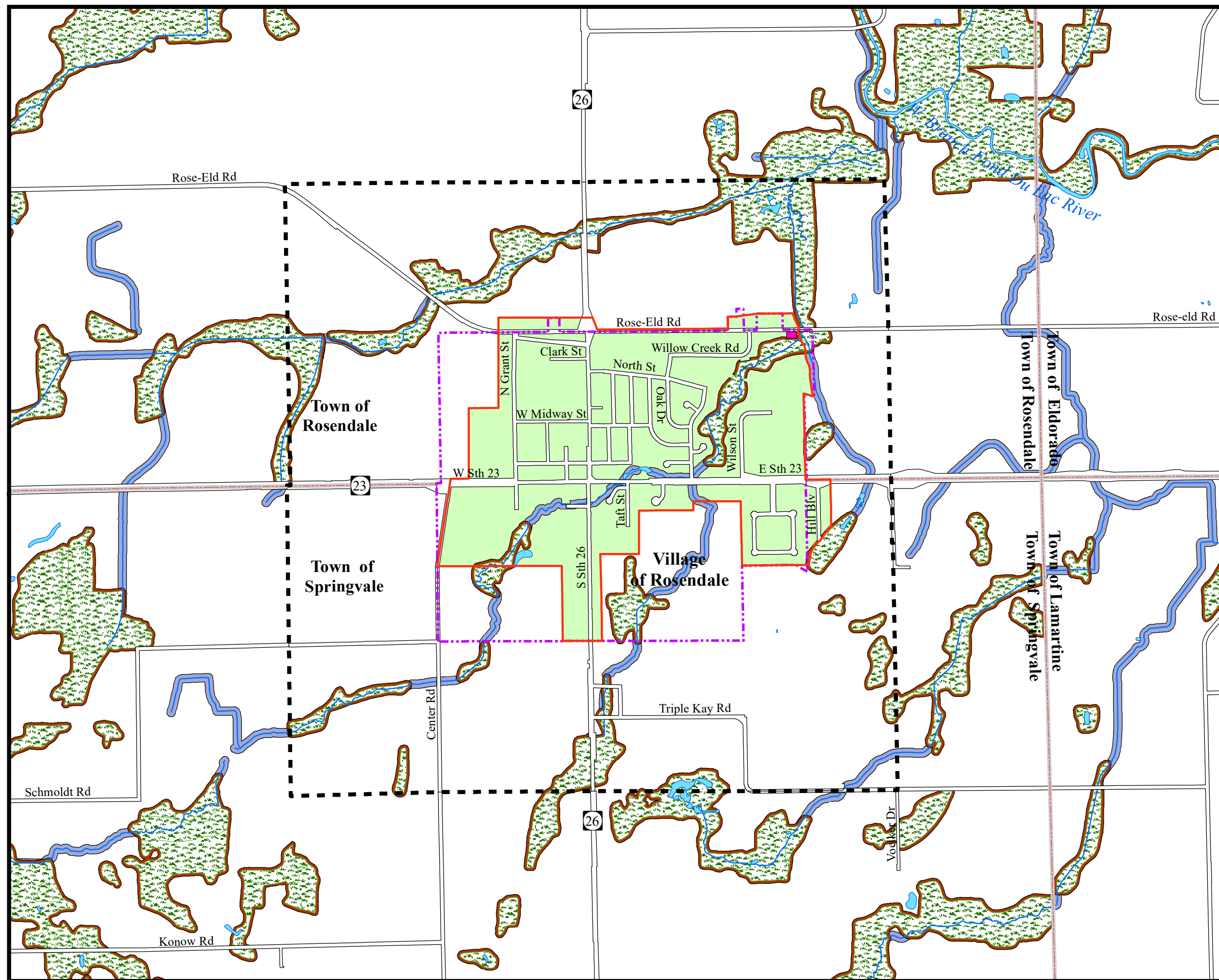

Prepared By
**EAST CENTRAL WISCONSIN
 REGIONAL PLANNING COMMISSION**
 JUNE, 2018

FOND DU LAC COUNTY

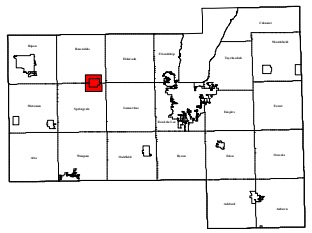

East Central Wisconsin
 Regional Planning Commission
ECWRPC
 Cassinell • Fond du Lac • Menominee • Ouzigama
 Shawano • Waupaca • Waushara • Winnebago

This data was created for use by the East Central Wisconsin Regional Planning Commission Geographic Information System. Any other use/application of this information is the responsibility of the user and such use/application is at their own risk. East Central Wisconsin Regional Planning Commission disclaims all liability regarding fitness of the information for any use other than for East Central Wisconsin Regional Planning Commission business.

Source: Digital base data provided by Fond du Lac County. Land Use data provided by the Town of Rosendale, Town of Springvale and Village of Rosendale. Wetland data provided by W DNR. Thematic data created by ECWRPC.

This map and its associated sewer service area descriptions do not obligate a community(ies) to provide sewer service to property owners contained herein.